

Masport®

Technical Bulletin Issue 78 - February 2011

Reel Mower Sprocket Change

As part of the continuous process of improving the quality of our products, changes have been made to the reel blades and reel sprocket on our reel mowers range. The old reel and sprocket, which were assembled together by means of a left hand thread, are replaced with a redesigned reel and sprocket using a keyway. Starting in **August 2010** from serial number **7353010**, the new parts have replaced the old ones in production. Pictured below are the new and old sprockets, showing the differences in construction between them.

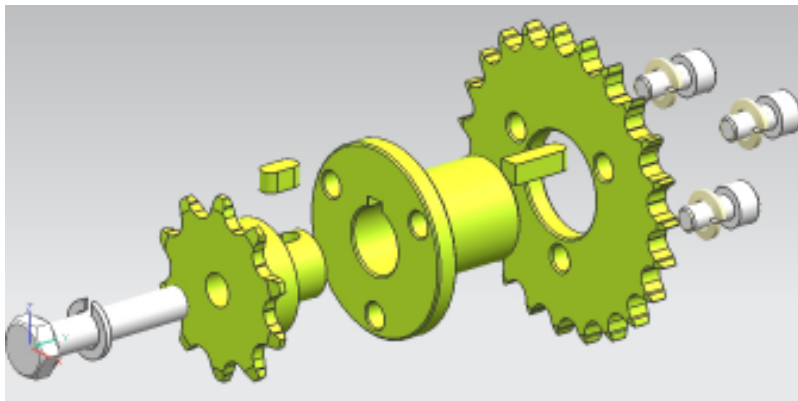

New - Sprocket Assembly - Key
P.N. 032006

Fits new reel blades :

032013 - 400

032014 - 500

032015 - 660

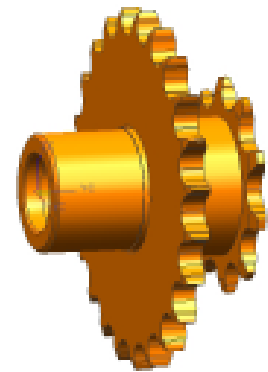

Old Sprocket Assembly - LH Thread
P.N. 004298

Fits old reel blades :

008924 - 400

008970 - 500

008980 - 660

Should a customer wish to use the new parts, both the new reel blade and the new sprocket will need to be ordered. The following new assemblies will be available for spares shortly:

932087 - Cylinder & Sprocket Assy 400 (032006 + 032013)

932088 - Cylinder & Sprocket Assy 500 (032006 + 032014)

932089 - Cylinder & Sprocket Assy 660 (032006 + 032015)

This is an informative bulletin only.