

W	PANEL THICK
* 19.2	0.75-1.25
19.4	1.25-2.0
19.8	2.0-3.0

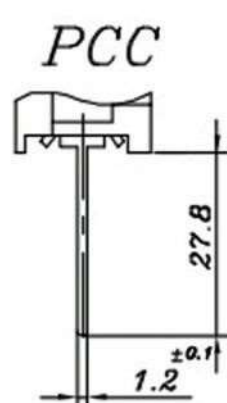
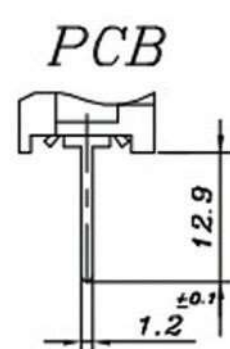
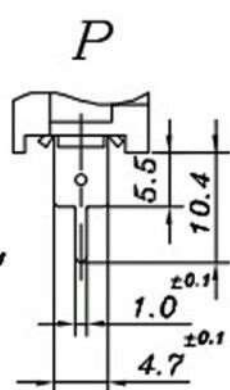
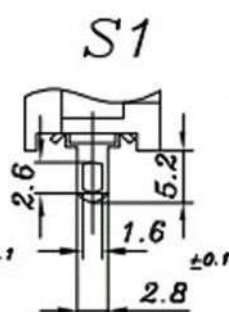
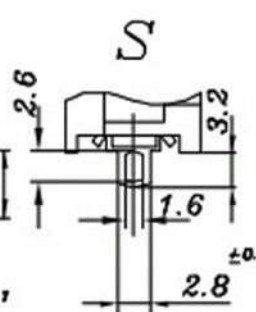
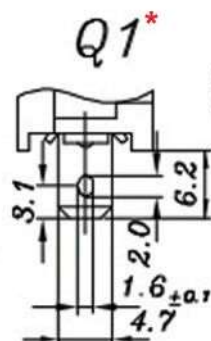
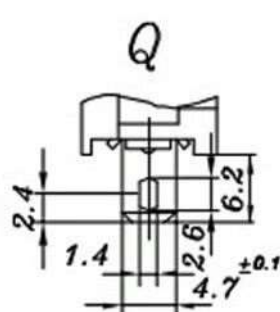
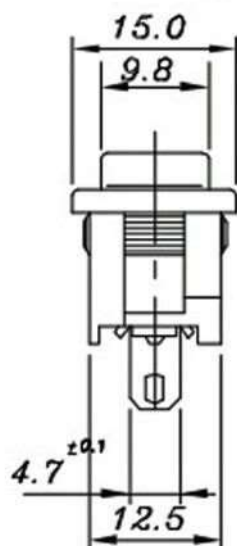
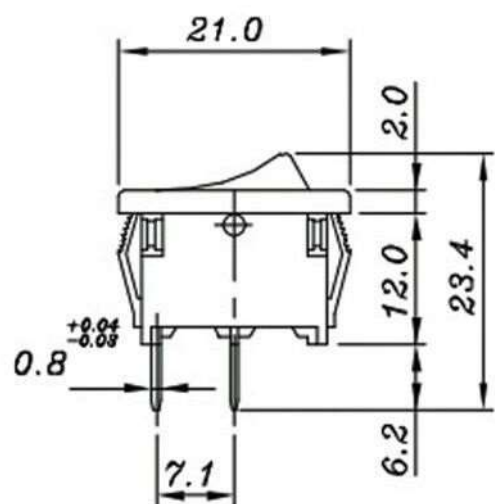
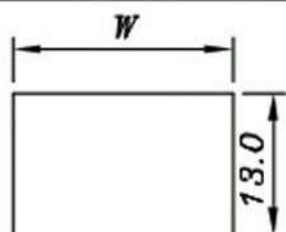

規格  
SPECIFICATIONS:

- 迴路  
CIRCUIT SPST : ON - OFF
- 定格  
RATING L : 5A 125VAC L : K  
K : 6A 125VAC/3A 250VAC :   
H : 10A 125VAC/6A 250VAC : 
- 接觸電阻  
CONTACT RESISTANCE. 30m Ω Max .
- 絕緣電阻  
INSULATION RESISTANCE. DC 500V 100M Ω Min .
- 耐電壓  
WITHSTAND VOLTAGE. AC 1000V 1 Minute .
- 作動力  
OPERATION FORCE 800±300 g .
- 電氣壽命  
ELECTRICAL LIFE 10,000 Cycles At Full Load .
- 使用溫度範圍  
OPERATING TEMPERATURE RANGE. -25°C~+85°C .
- 焊接  
SOLDERING 280°C FOR 3 Sec .